

40'-0"

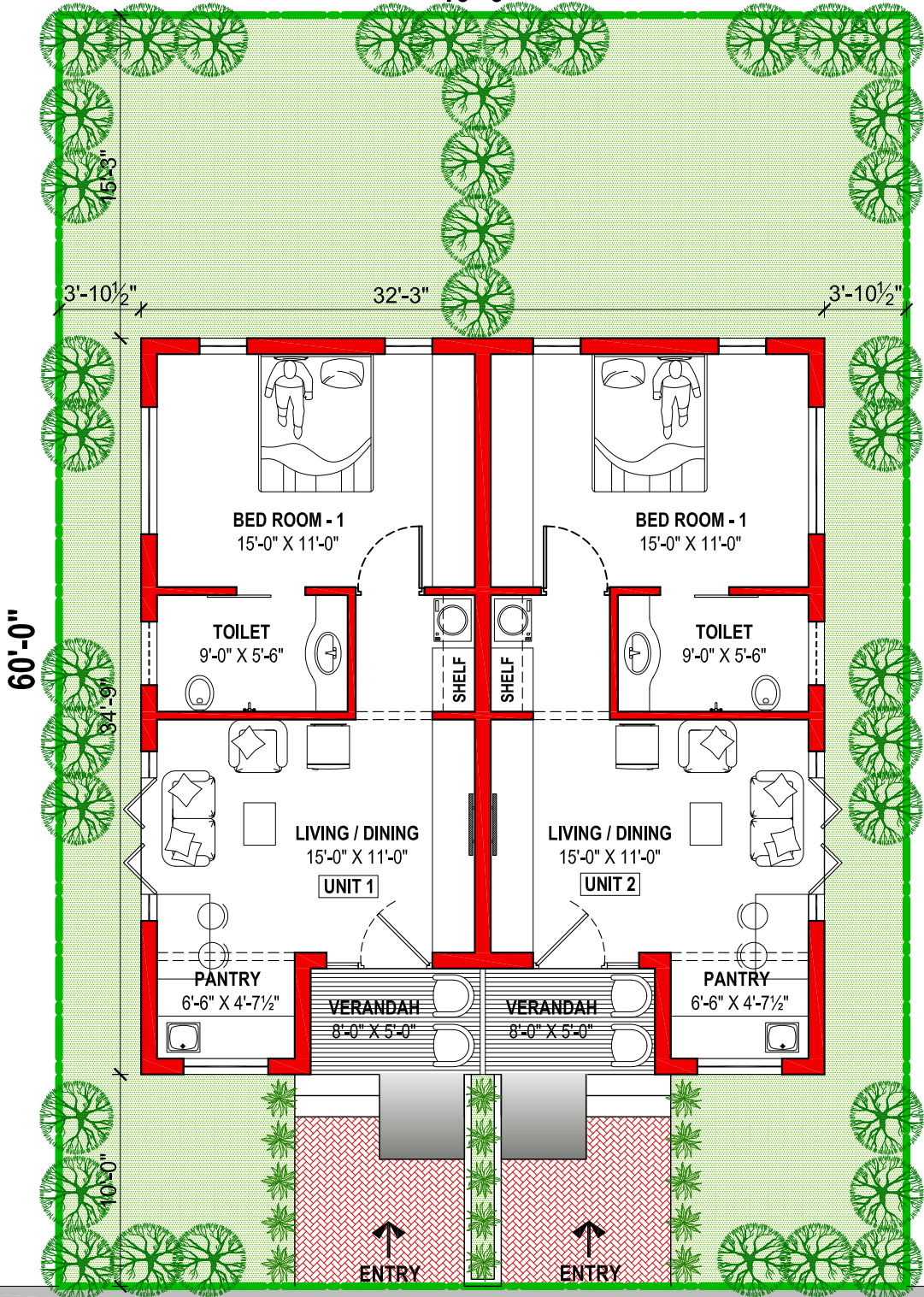

40'-0" WIDE ROAD

**Notes:**

1. All Dimensions Are In "feet & Inches".

**Area Details:**

Plinth Area Of The Building (Including Verandah)	= 1120 Sq.ft
Area Of Unit 1 (Including Verandah)	= 560 Sq.ft
Area Of Verandah	= 40 Sq.ft
Carpet Area	= 447 Sq.ft
Area Of Unit 2 (Including Verandah)	= 560 Sq.ft
Area Of Verandah	= 40 Sq.ft
Carpet Area	= 447 Sq.ft

**40' X 60' SITE  
(1 BHK EACH)TWIN HOUSE PLAN**

**WEST FACING  
SITE NO: 61,62 & 63**

NORTH



08.05.15	02	BUILDING AREA REDUCED	CLIENT
10.04.15	01	AS PER DISCUSSION DATED ON 07.04.15	CLIENT
DATE	REV NO	DESCRIPTION	REV BY



**Design Forum** India Private Limited  
ARCHITECTURAL & STRUCTURAL ENGINEERING CONSULTANTS.  
COIMBATORE - 641 037. PH : 0422 - 2241661, 2241676. FAX : 4388661.

CAD FILE	SYS - 13	CLIENT NAME :	
SCALE	TO FIT	<b>Vedaanta Senior Living Chennai</b>	
DATE	31.03.15	PROJECT CODE	PROJECT NAME :
DESIGNED	Ar.Preethi	<b>Vedaanta's Brindhavanam Coimbatore</b>	
DRAWN	vimala	J - 013	
CHECKED			
DRAWING TITLE	GROUND FLOOR PLAN		REV NO
DRAWING NO	SCHEME DRAWING		02
		SHEET	APPROVED
		- OF -	